

50 747 Roll net
EAST NET

27/04/15 - 14/07/15

OP Bredic

[REDACTED]

[REDACTED]

[REDACTED]

Monday 4 May 2015

0800. ON DUTY - KIRKCUROY PS.

DUTY HOURS 0800 - 1600

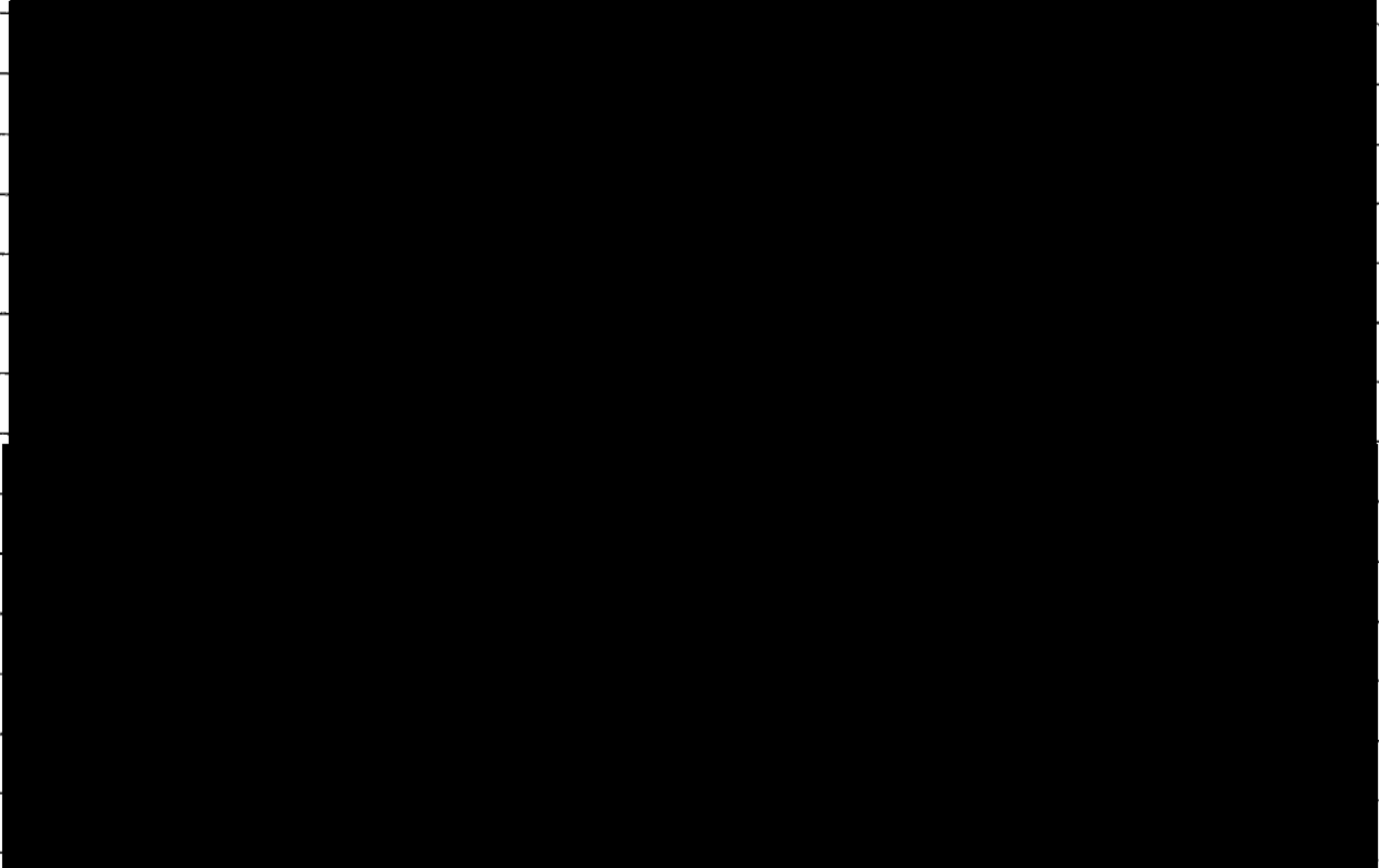

0830. BRUCENA - 07 HAMILTON

MEETING @ 1000

INSTRUCTED BY DCI HARVE - WILL
require to assist as COM for
death in KIRKCUROY yesterday

CONSIDERATIONS

- 10 CRIME SCENES.

- | | |
|---------------|-------------------------|
| 1. LOUPO. | 4. H/A. |
| 2. TRANSPORT? | 5. ADDRESS OF WITNESSES |
| 3. DECEASED | 6. ADDRESS OF WITNESSES |

- PHOTO, 360, VIDEO, SKETCH.
- SEARCH, SOLO, POLICE, DRUGS OFF.
- COORDIN, CAR, SCENE ENTRY LOG.
- SCENE ADD.
- PLE TIME?
- INQUIRIES?
- CLOTHING?
- DEWU?/STOP.
- CLOTHING?
- WARRANTS?
- FORENSIC STRATEGY?
 - initial parameters
 - key actions.
 - sequential order.

Locs.

- Collette Bell's address at Arran Crescent [REDACTED] - HIA
 - Dick/Macleod home address [REDACTED] - watched being
- MARTIN DICK'S HIA
 - Saeed home address [REDACTED] - locus of CALLER
FIGHT? - SIG. WITNESS
SAED - CHANGED CLOTHING?
 - HAY DRIVE - outdoor locus.
JANE HARVEY (Amen 12m).
- TEAM LEXAR - Gordon Young [REDACTED]
BRIAN O'NEILL
PETER BRADY

DECEASED: SHEKU BAYOH. @ SURRA COND.
3. 30/09/1988.

SAYED SAYED. - STA. WITNESS.

friction, back to OICK'S watched boxing
deceased become paranoid, and up
at Saeed home address, purple/white pills
out of sock, flushed by SAYED - had
a fight and stormed off - 0500 approx

Deceased went home. 0700 - black
male carrying knife - Cop attended -
restrained, PAVA, CS - no effect
baton strike, possibly to head, H/C
to rear, leg restraints, - went BRU
CPR - Ambulance - Hospital

PL's @ 0904 PM this afternoon.

1000. BRIEFING - OF BIRNIE - OSUP CAMPBELL

PIRC - LEAD ENQUIRY

5-Loer.

1. ~~DECEASED / HOS~~
2. ~~ARRAN CRESC. COLLETTE BELL #1A~~
3. ~~HOSPITAL W/20~~
4. ~~MARTIN DICK'S #1A~~
- 5.

- PM - HOS today.

1. ~~DECEASED~~ - complete and lodged
2. ~~HOSPITAL~~ LEAD - LOCS.
 - 360. Photos. - Scottish Water - Drains
 - RP - collision Obs.
 - PWSA - roadway/pavement
 - gardens etc. still required.
 - HE from PIRC?

3. [REDACTED] Collette Bell's address at Arran Crescent - DECEASED #1A
- Evidence from PM.
 - knife away from set?
 - kitchen drawer open?

4. [REDACTED] Dick/Macleod home address - MARTIN DICK'S #1A
- verbal argument.
 - record near time

5. SAAD #1A - now returned. [REDACTED] Saeed home address
- clothing recovered

SEAT TRENDO. [REDACTED]

→ seized @ ACE, [REDACTED]

- conveyed N/A. - vehicle.

6. Officers Equipment etc. seized

- ASSESS - knife slash? disturbance
- RECORD.
- WARRANT? - permission given.

PRIORITIES.

- PM.
- Lees. Progressed.

COM RECEIVING - DCI HORTON

* Dick/Macleod home address

- ASSESS.
- PHOTOGRAPH (GENERAL)
- CLOTHING ON BED?

* ALLAN CRESENT.

1130. Attended HAYWOOD ROAD, KIRKCUDDRY
with DC Brian MORRIS (COM).
Awaiting PORPA.

1400. Attended

Dick/Macleod home address

with JUDITH HALEY - DC
ROBERT YOUNG - SDC.

Initial Assessment and Recording
General Photographs - Taken inside/out

1358 * instructed officers to commence scene entry logs

End Terrace front/rear

FRONT. front garden enclosed by 3 foot fence; ^{path} gravel driveway way to [REDACTED] Dick/Macleod home address

20 steps - front door 2 windows, 1 down, 1 up windows closed, blinds closed, small porch, blinds open security light

General photographs taken externally,

Entered - full forensic precautions - gloves, overboots, suit, mask

DOWN - STAIRS

Porch - shell, shoes, various. (size 13).
Living Room - wood/laminate, 1 couch, 2 x chairs - black leather, TV, dog/cat bed, ashtray - 5 x cigarette butts, pint glass with liquid on floor between 2 chairs, car keys on floor with [REDACTED] key fob, belt on couch, stairs, jacket hanging on banister - black with maroon chevron, solid maroon on shoulders and chest and hood, zip up jacket. "Bonfire Snowbear with Company". Aldi carrier bag on floor, empty bit piece of paper, on floor beneath stair case.

No signs of disturbance

Carpet upstairs -

A Herbal Matter in jar in bed drawer

Downstairs

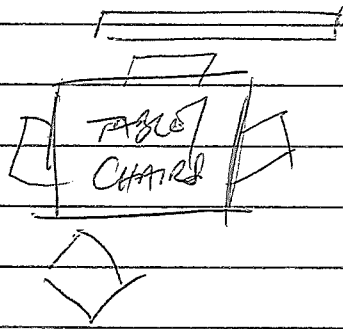

SINK

FRONT DOOR

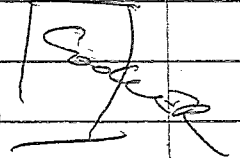

STAIRS

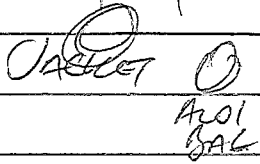

CHAIRS

PINT GLASS

CAR WASH

2x DINE TABLES

TABLE

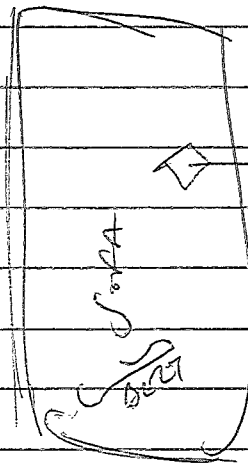

ASH TRAY

LAMP on table

FRONT DOOR

FRONT DOOR

UPSTAIRS

Clutter - black mesh frames, sack white fabric white/yellow body

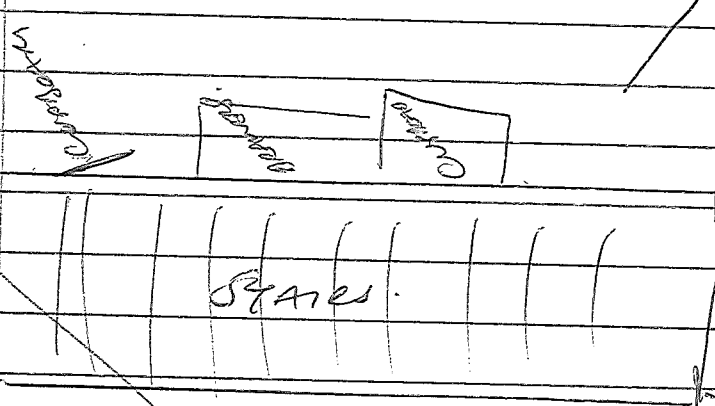
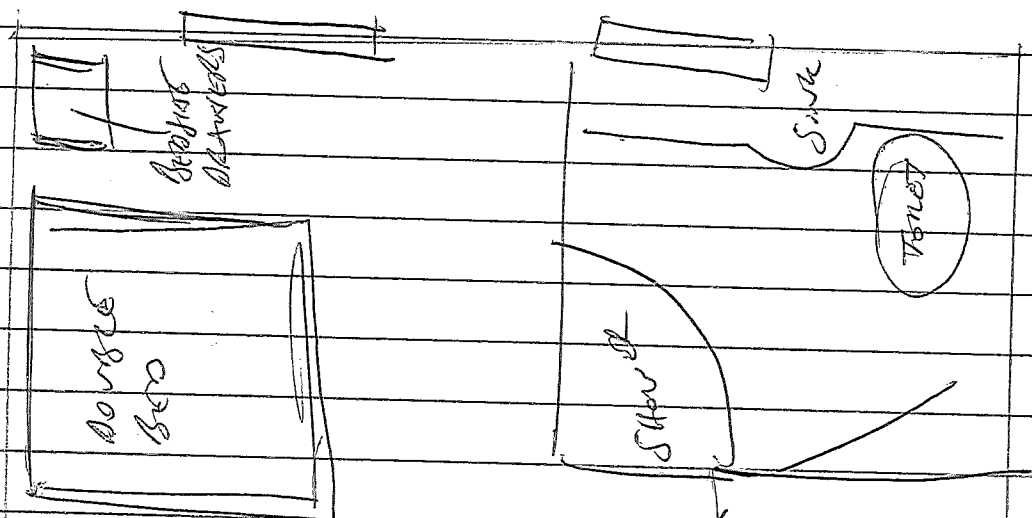

male female clothing

Cupboards

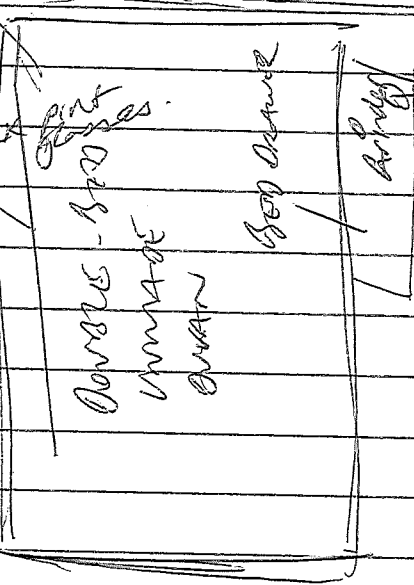
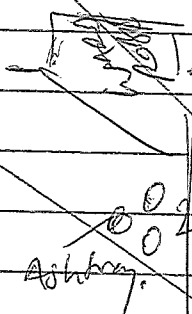

Carpet with pieces of herring of mather.

Rabbit for clothing

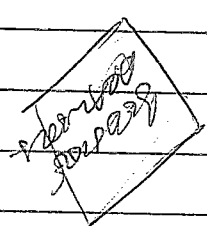
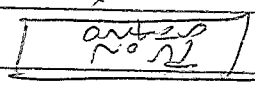
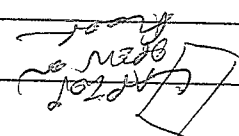

Ward - bureau dress

Drawer in kitchen - upper to right of
cooker hood - contains knives, mostly
black handled of various styles / size
None obviously missing

145g. Exit -

Rear garden enclosed by 6-foot fence
small 6x3 shed

Parked off to side - Ford Transit

[REDACTED]

~~145g~~ 145g

1530-1535 Re-entered with Smith Harvey to
access Herbal Matter in bed drawer,
main bedroom

2x grinders - trace amounts
Wander box - paraphernalia - each,
papers.

Plastic Jar - trace amounts

PF - KIKKADON - warrant
- warning

[REDACTED]

Circs:

Dick/Macleod home address

Currently held by police as
crime scene.

Occupiers are:

Martin Dick

Kirsty Macleod

B. [REDACTED] 1986

B. [REDACTED] 1988

- Scene is held and has been examined
on a voluntary basis in relation to the
death of a male in Kirkcaldy
yesterday. Male died following police
contact.

- During course of ~~search~~ ~~accessing~~
leaves - observed trace amounts of
cannabis - £1-£2 worth, 2 grinders.

- Seeking advice - can this be seized
without warrant? If not, can a JP
be approached?

Dealing with 2x occupiers - caution and
charge ~~SAW~~ or circumstances
reported?

Scott DUNNORTH - ACC

DEV KAPADIA - PF ON CALL

related to investigation?
Putting per through it
No wanting to bother Sheriff

1700 spoke to ATN. - PF

Operational Matter
from prosecutor point of view - nothing
will be done

Collette Bell's address at Arran Crescent

- Domestic PHOTOGRAPHERS.
- depends on whether further work to
(scripts) be done
- feeling for further examination

~~1830~~ 1900.

- recorded and disturbance recorded
- recover knives?

I have reason to believe that the
substance found in your possession is
a controlled drug under MSA 1977.
Should analysis of the substance(s) prove
positive you will be reported for
offences under the act

I must caution you.

1818

Entered

Dick/Macleod home address [redacted]

w/ta SC microscope. Mesh, gloves, overboots

1820

Seized

LABEL No. DRAWER 1 -

[redacted]

Dick/Macleod home address [redacted]

LABEL No. DRAWER 2 -

[redacted]

Dick/Macleod home address [redacted]

LABEL No. TON CONTAINING HERBAL MATTER -

Dick/Macleod home address [redacted]

from within rear ^{RIGHT} ~~left~~ drawer of
Duvan bed in bedroom 1.

1825

Exited.

1839

Loose food down seized: -

LABEL No. SCENE ENTRY LOG -

Dick/Macleod home address [redacted]

Informed by DI Wilson NOT to
send phone

1840 KERRY MACLEOD

S. [REDACTED] /1988 @ [REDACTED]

Dick/Macleod home address
[REDACTED]

1840 MARY [REDACTED] DICK

S. [REDACTED] /1986 @ [REDACTED]

I acknowledge my home address
has been returned to me and
there is no damage or missing
items.

X [REDACTED]

1842 AN'S, read drugs center - v/s, n/r

1900 Attended ARRAN CRESCENT, KILKEARNEY,
with DSE Gordon Young, SE JUSTA HARLEY.

located within front garden of No. 14.
Gold "Citizen" bracelet watch with open
clasp. STM photo and seized.

Entered [REDACTED] Co ette Be address at
Arran Crescent - full forensic protection.

1920.

EXTERNAL -- FRONT

windows locked, front door locked
front garden, walled. 4x out to front
UPVC, front door, single north-pent lead
mid terrace

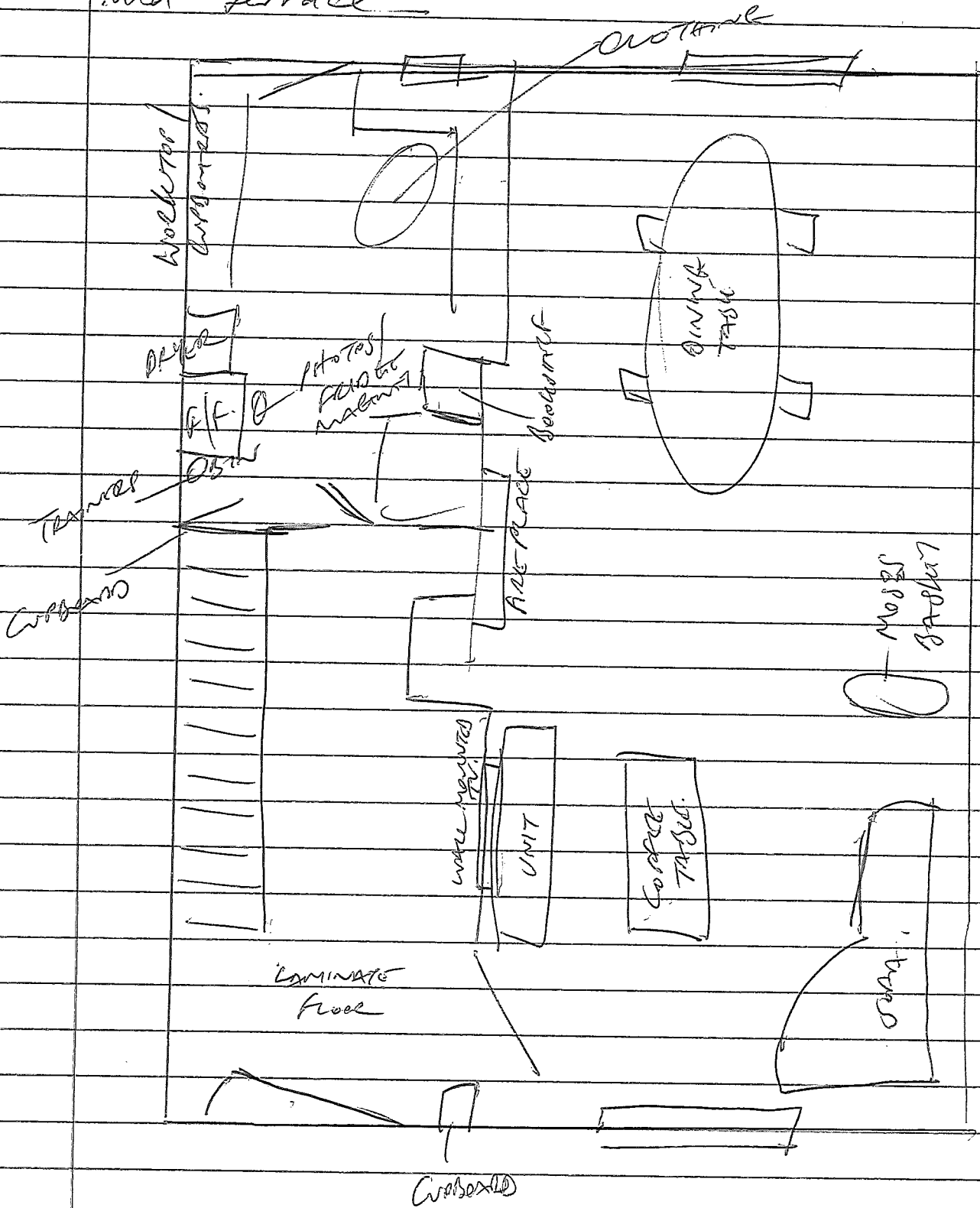

DEMONSTRATE

HALL - laminate flooring, rug at front door and rug between of stairs.

White Apollo Mopu MTS - front suspension
Coat Rack - shoes, coats, hand bag, cap

Living Room - laminate flooring, single sofa, coffee table upon green rug

* Mobile phone on top of unit beneath wall mounted TV.

Black/silver mobile - samsung within case, sticker BAYOH - various cards within phone case in N/A name

fireplace, dining table, 4x chairs, curtains at rear closed. light over dining switched on. Stereo system on bookshelf
Noses basket, shredder, on floor
No signs of disturbance

kitchen - lino flooring, 2x fridge magnets and 4x strips of photos including A/O.

* Brewsch, red on top of dryer, all cupboards and drawers closed. Rear door locked, blinds closed.

Clutter on floor - 1 hoodie, 1 jacket
Medication on top of fridge/freezer.

UPSTAIRS - 2 bedrooms, bathroom
cupboard

Rear bedroom - child's room,
cot, drawers, chair. window closed
curtains open, light off, shelving unit
under window. Gold watch on floor.

v. clean + tidy, no signs of disturbance
bathroom - sparse, clean.

* front bedroom - small flat screen, 14"
approx TV on floor open entering,
plugged into aerial on floor further
into room, double bed, built in cupboard,
x2, chest of drawers, wardrobe
2x windows - closed, curtains closed,
light off.
Undry, clothing, falsebricks, iron on floor.

OUTSIDE AREA

4x falsebricks manure - 1st birthday party
invite on floor, scattered 4meters
leading to back door.

3 meters from gate - silver wrist watch
TRAZER pin broken on trap where
it neck held.

2045. Exited

RETRN.

2025 Commenced search of locus with
DE STANFORD - 1094.

2020. Seized :-

1. " BOTTLE OF 56 TABLETS LABELLED
CREATINE "

(top of fridge/freezer - kitchen)

2. " BOTTLE OF 33 TABLETS LABELLED
HERBAL V4 FOR MEN. "

3. " BOTTLE OF 48 TABLETS LABELLED
RHODIOLA ROSE "

4. " BOTTLE OF 38 TABLETS LABELLED
TESTOSTERONE BOOSTER "
(ingredients - creatine).

5. " BOX OF 27 TABLETS LABELLED
OMEPRAZOLE "

(Gastro - resistant capsules prescribed
to STEVEN BAYDOL).

6. " BOX OF 7 TABLETS LABELLED
OMEPRAZOLE "

7. " ~~7005 TABLETS~~

16. COSE TABLETS "

- similar in appearance to
creatine and test. tabs.

- Recovered from front pocket of
red envelope on top of dryer,
kitchen of

Collette Bell's address at Arran Crescent

10 purple - creatine
6 red/white = test.

2100. Handed from Gordon Young / Smith Harley

- 1920. 1. JAH004 - WATCH ←
- 2025 2. JAH005 - MAGNET ①. FRONT GARDEN OF 14,
- 2025 3. JAH006 - MAGNET ② } PATHWAY TO
- 2025 4. JAH007 - MAGNET ③ } REAR DOOR, REAR
- 2025 5. JAH008 - MAGNET ④ } GARDEN OF
- 2030 6. JAH009 - WATCH ② } ~~GRASS TO ROAD~~

Collette Bell's address at Arran Crescent

To do:

- 1. PROOF - from Dick/Macleod home address
- FIELD TEST
- COMPLETE LABELS
- ERF
- PROOF AWAY.
- REPORT.
- SCENE LOG.

2. Loose PROOF from

Collette Bell's address at Arran Crescent

3. Book up-to-date

④ COM REPORT.

7. ESTABLISH WHO HAS HAD ENTRY

TO Dick/Macleod home address PRIOR TO USE

5. Notebook up-to-date

6. SCENE LOG FOR APPROX

8. SCENE LOG FOR

Dick/Macleod home address

2130. OFF DUTY.

TUESDAY 5 MAY 2015

0800. ON DUTY - KIRKCAROY PS.
DUTY HOURS 0900 - 1600

SUMMARY OF YESTERDAY'S WORK

1. Dick/Macleod home address

H/A of MARTIN DICK

- Initial Assessment, still photographs.
- No sign of disturbance.
- Side issue - Herbal Cannabis recovered, occupiers cautioned.
- Leads stood down 1839.

2. ARKAN CRESCENT, KIRKCAROY

H/A of OCCASER

- Gold bracelet watch recovered from front garden of No. 14
- 2 possible locations of disturbance;
① KITCHEN/REAR GARDEN - fridge magnets on floor, possibly knocked off from fridge, 4x magnets o/s on path, 2 metre trail leading from back door, watch in rear garden towards rear cartilage - broken pin where strap meets bezel - silver bracelet watch
- ② BEDROOM 1 - small TV on floor near to door. Appears to possibly lie on chest of drawers 2 metres away.

* 3x knives recovered from
kitchen drawer - silver blade,
silver metal handle, varying
sizes - similar to one recovered
at Hayfield, Road, "House and
Home" on knife edge

* various tablets and
medications recovered

RETR0.

2030, 04/05/15

Recovered from second drawer down
kitchen of Collette Bell's address at Arran Crescent

1. KNIFE 1
2. KNIFE 2
3. KNIFE 3

BRIEFING - SCI HAZARD / ST WILSON
OPERATION BIRNIE

PM. - bruising legs - restraints
Left hand bruised
Blunt force to head
Haemorrhaging to eyes - consistent
with restraint/positional asphyxia
bruising to wrist.
Irrain - cloudy - possible infection
causes victim to be delusional
Cause of death - unascertained pending
lab and neurology.

A CAR - white car - damage consistent with
Robbing?

Left off Arora Crescent - robbery @ 0630.
Seemingly deceased fighting, in possession of
knife

Dark Car from [REDACTED] - pedestrian crossing over
before Henry Road - deceased - appears
to be carrying silver item in right
hand. Audio - passenger says he's
got a knife in his hand

* forensic Strategy - knife up to lab - ~~not~~ ~~for~~ ~~analysis~~

SCENE TOURS. [REDACTED]

- witness talks of a white car being stabbed, - any marks consistent with this

ACE RECOVERY [REDACTED]

1630.

- search interior - weepers/knives
- drugs - delusional

* 1140. DC GILBERT handed me Scene Entry Log for [REDACTED]

Collette Bell's address at Arran Crescent

[REDACTED] and instructed to add label: -

Label no. SCENE ENTRY LOG -

Collette Bell's address at Arran Crescent

* 1140 - instructed by DC MOORE to handover all productions to DC GILBERT, despite field test not being completed and scene logs not complete